



Board drillings for connectors with right angled pcb contacts

Identification

Drawing

Dimensions in mm

Male connector*

2W2 / 2W2C

Power contact

Coaxial contact

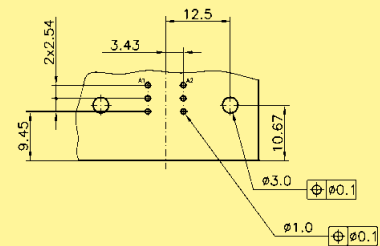
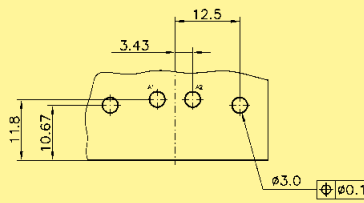

3W3 / 3W3C

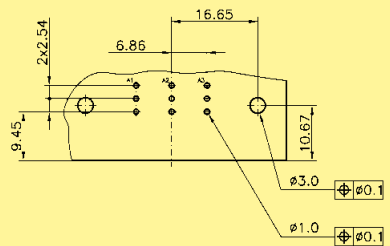
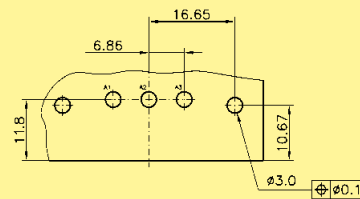

5W1

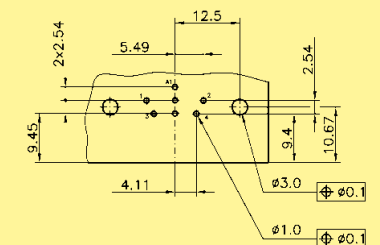
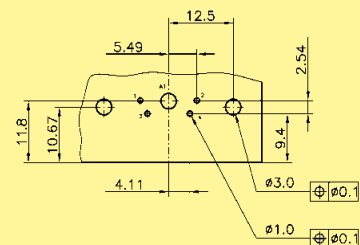

5W5

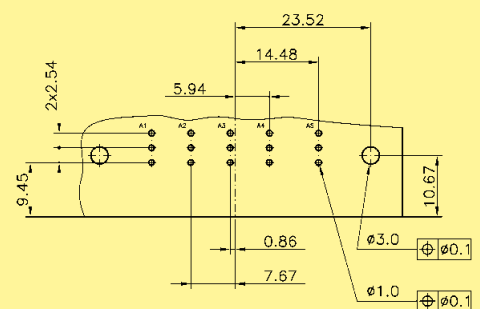
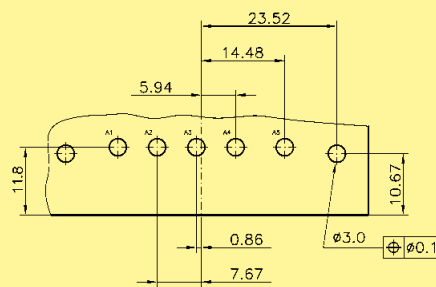

7W2

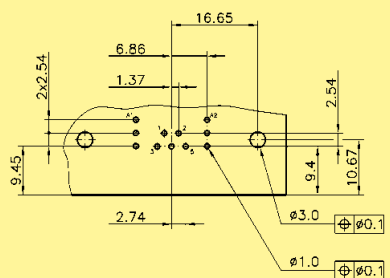
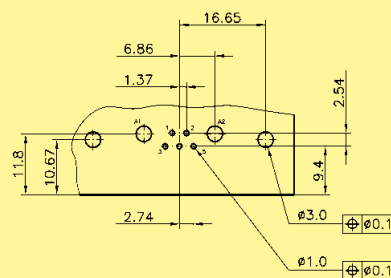

* When using a female connector with right angled pcb contacts the board drilling pattern must be mirrored in the Y axis.