

Number of contacts

# 9-25

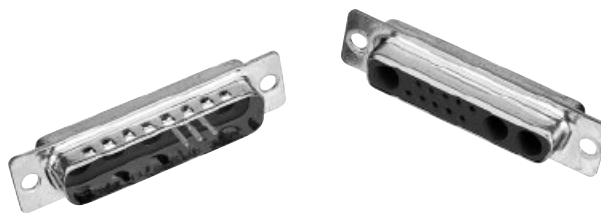

Mixed shells with pre-mounted signal solder cup contacts

Identification	No. of contacts <sup>1)</sup>	Part No.			
		male connectors		female connectors	
		Performance level 3	S4 <sup>2)</sup>	Performance level 3	S4 <sup>2)</sup>
	9W4	09 69 311 7094	09 69 311 5094	09 69 301 7094	09 69 301 5094
	13W3	09 69 311 7133	09 69 311 5133	09 69 301 7133	09 69 301 5133
	25W3	09 69 411 7253	09 69 411 5253	09 69 401 7253	09 69 401 5253

Male connectors

**9W4**

Solder cup termination for AWG 20 (0.5 mm<sup>2</sup>)

**13W3, 25W3**

Solder cup termination for AWG 20 (0.5 mm<sup>2</sup>)

	b	c	d	e
13W3	53.0	41.3	47.04	38.90
25W3	69.3	57.7	63.50	49.84

Dimensions in mm

D-Sub - M

<sup>1)</sup> Explanations see page 04.03  
<sup>2)</sup> S4 = 0.76 µm Au or PdNi equivalent  
 Board drillings see pages 04.30 ff

Drawings for female connectors see page 04.09  
 Order special contacts separately. See pages 04.21 ff