

Number of contacts

# 9-50

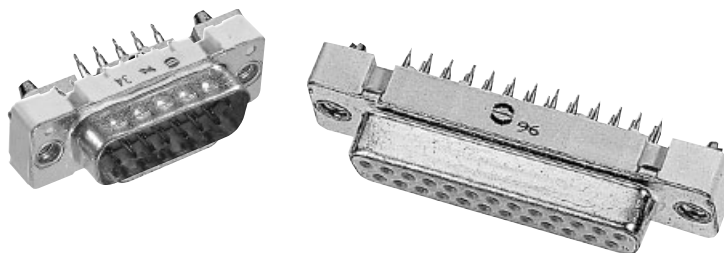

Press-in, straight with grounding press-in board locks

Identification	No. of contacts	Part No.	
<b>Performance levels</b> Explanations see page 20.08 Other performance levels on request		Performance level <b>3</b>	Performance level <b>2</b>
<b>Male connector</b> Flange height x = 5.7 mm			
metal shell with dimples	9 15 25	09 66 164 771 09 66 264 771 09 66 364 771	09 66 164 671 09 66 264 671 09 66 364 671
Please insert digit for flange thread or fitted female screw locks			
M3 ▶ 5 4-40 UNC ▶ 6 fitted screw locks 4-40 UNC ▶ 7 <sup>1)</sup>			
<b>Female connector</b> Flange height x = 5.7 mm			
metal shell	9 15 25 37	09 66 154 751 09 66 254 751 09 66 354 751 09 66 454 751	09 66 154 651 09 66 254 651 09 66 354 651 09 66 454 651
Please insert digit for flange thread or fitted female screw locks			
M3 ▶ 5 4-40 UNC ▶ 6 fitted screw locks 4-40 UNC ▶ 7 <sup>1)</sup>			
<b>Female connector</b> Flange height x = 6 mm			
metal shell	9 15 25 37 50	09 66 154 751 09 66 254 751 09 66 354 751 09 66 454 751 09 66 554 751	09 66 154 651 09 66 254 651 09 66 354 651 09 66 454 651 09 66 554 651
Please insert digit for flange thread or fitted female screw locks			
M3 ▶ 1 4-40 UNC ▶ 2 fitted screw locks 4-40 UNC ▶ 3 <sup>1)</sup>			

Press-in technology

20  
10

<sup>1)</sup> Fitted screw locks 4-40 UNC not normally kept in stock for performance level 3  
 Connector dimensions see page 20.11. Mating conditions see page 20.08.